

*Smart Door lock*

# *USER MANUAL*

Orion

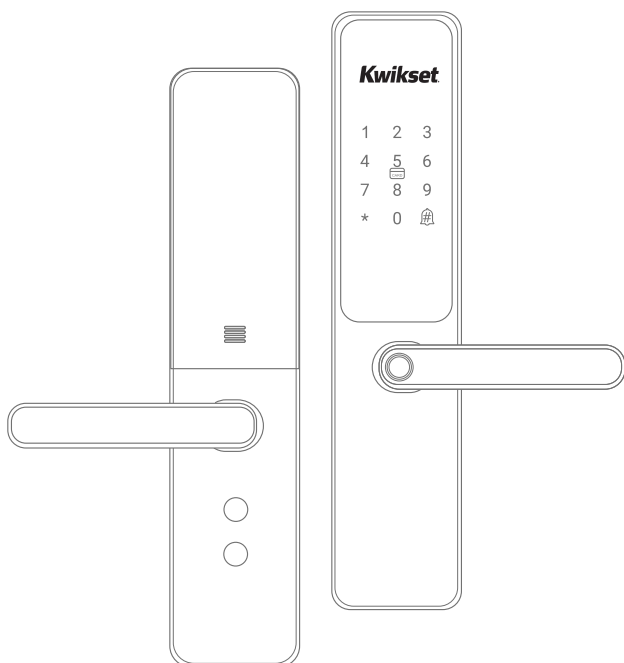

# Contents

1. Product image.....	P1
2. Product parameter.....	P2-P3
3. Function and management.....	P4-P5
4. Daily operation.....	P6-P7
5. Door opening direction.....	P8
6. Scope of application.....	P8
7. Exploded View.....	P9
8. Installation procedure.....	P10-P12
9. Daily maintenance.....	P13
10. Contact us.....	P14

# 1. Product Image

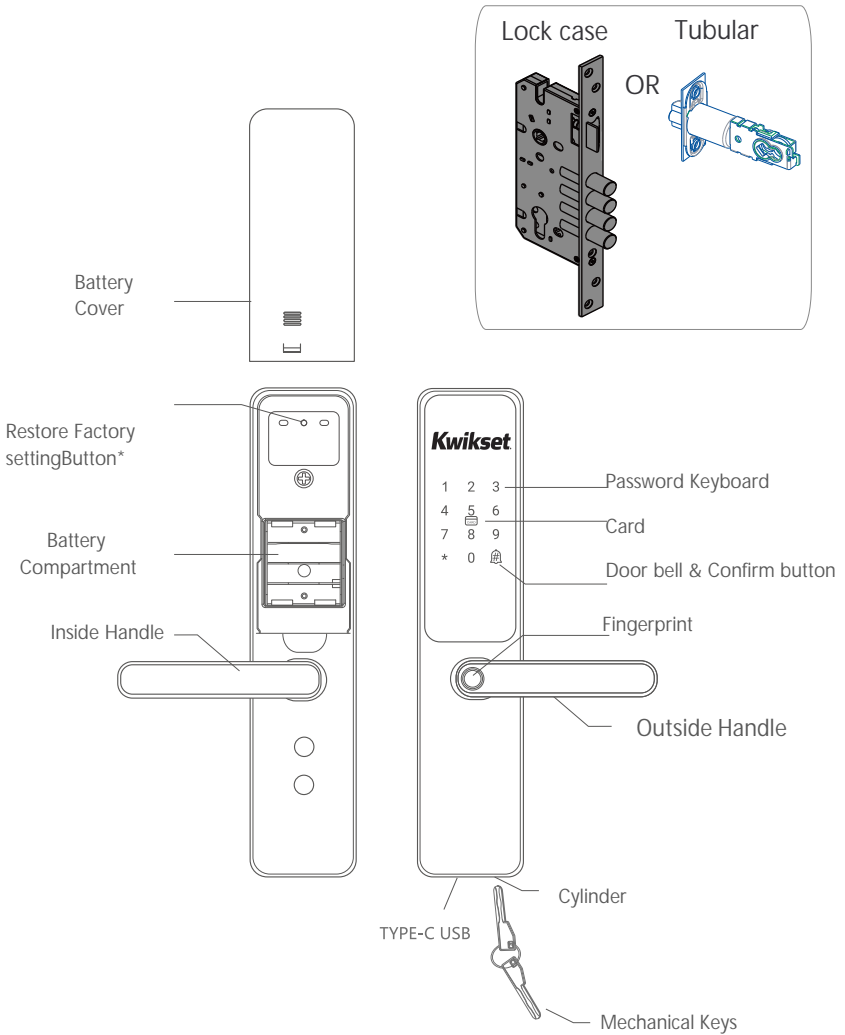

## Resetting button

When the door lock is powered on and in sleep mode, press and hold the reset button for 6 seconds. After the voice prompt, press the '#' key to confirm and reset the lock to its factory settings.

### ▲Note

After restoring the factory state, all user registration information will be cleared.

## 2. Product parameter

Product Parameters	
Master chip	STMicroelectronics (ST) G030
Motherboard size	54 X 40 (mm)
Fingerprint/Password/Card capacity	Total capacity 300 groups 9 groups of administrators, 291 groups of common users
Password length	6-12 Digits
Dummy password	20 Bits
Fingerprints	100 Pieces
Fingerprints Collector	Semiconductor
Card type	IC Card
Unlock method	Fingerprint+Password+ Card
Alarm function	Support 5 trial and error alarms, tamper alarms, low pressure alarm function
Power supply	4.5V-6.0V , 4 AA batteries
Emergency power supply	5V USB emergency power supply
Low voltage alarm voltage	4.8±0.2V
Normally open mode	After the administrator unlocks, press 5+#
Voice navigation	English
Keyboard	12-key capacitive touch keyboard
Unlock time	≤ 1 second
Local unlock record query	Not support

## 2. Product parameter

---

Product Parameters

Operating temperature	-25°C-70 °C
Working relative humidity	0%-93%RH
Motherboard fingerprint module interface	1.25 Pitch 6P+ FPC 6P
Fingerprint comparison time	≤ 1 second
Fingerprint sensing time	≤ 0.5 seconds
Fingerprint recognition rate	≤ 0.1
Fingerprint rejection rate	≤0.0001%
Fingerprint recognition angle	360 degrees
Quiescent Current	≤60uA
Dynamic current	≤180mA
Anti-static interference level	Air discharge: ±15KV
	Contact discharge: ±8KV

# 3. Function and Management Settings

## 3.1 Terminology, function key description

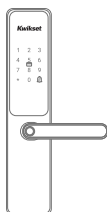

- 1) Administrator information: It means administrators fingerprint, password or IC card.
- 2) Unlock information: Refers to the entered fingerprint, password or IC card information ( Including administrators and ordinary users).
- 3) "\*" key: Clear key/Back key/Exit key.
- 4) "# " key: Confirm key.
- 5) Administrator mode: Press "\*" "# " to enter administrator menu.

## 3.2 Initial state (Factory state)

- 1) In the factory state, any fingerprint or any card or enter the factory password "123456#" to unlock the door.
- 2) After the administrator information is entered, the fingerprint, card or password that has not been entered cannot be unlocked.

## 3.3 How to enter the management setting mode

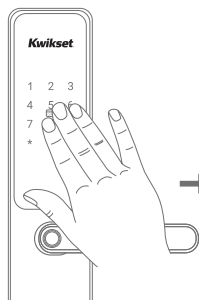

In the initial state, touch the digital panel, light the screen, long press "\*" "# " key + 123456 to enter the door lock function management menu, ( Administrator management the initial password is"123456" ).

Voice broadcast:

Administrator settings	Press 1
Ordinary user settings	Press 2
System settings	Press 3
Restore Factory settings	Press 4

# 3. Function and Management Settings

## 3.4 Management settings menu

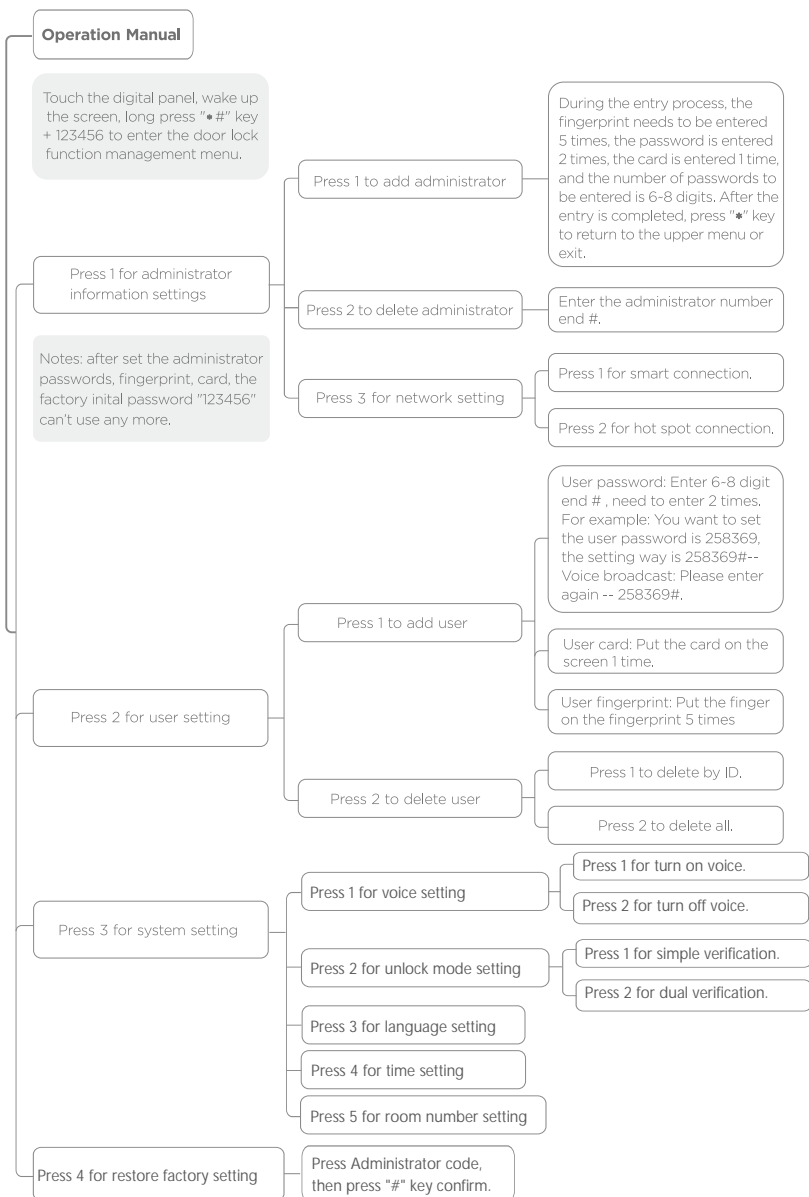

# 4 . Daily Operations

## 4.1. In commom mode

### 1. Password unlock

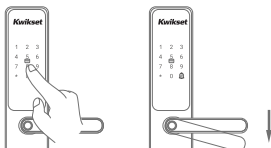

Tap the panel, enter the registered password, press "#" key to confirm, password verification success then voice plays "unlock", please press handle to unlock.

**▲ Note** Anti-peeping function: when you log in with a password, enter the password as follows: XXX password XXX, you can add some irrelevant numbers before and after the password, and then press # to confirm, the password must be included in the entered content.

### 2. Fingerprint unlock

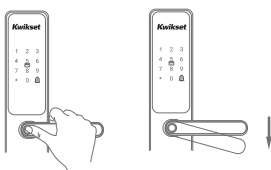

Press the registered fingerprint in the fingerprint collection area. After the fingerprint verification is successful, the voice prompt "Unlock" is heard. Press the handle to unlock it.

### 3. Card unlock

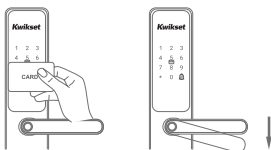

Put the registered card on the card area of key board, card verification success then voice plays "unlock", please press handle to unlock.

## 4.2. Emergency opening method

### 1. Mechanical key unlock

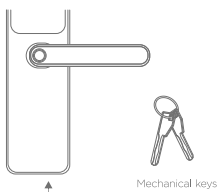

In case of an emergency, forgot the password, the battery runs out and if the system is not working properly, the spare mechanical key can be used to open the lock.

Input the key on the key hole (bottom at the end of outside panel) then turn the key, press the handle to unlock.

**▲ Note** During turning key, can't press the handle.



## 4 . Daily Operations

### 4.2. Emergency opening method

#### 2. USB emergency powers supply

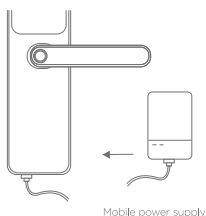

When the battery is exhausted and there is no key, you can connect an external power bank with C-type USB (bottom at the end of outside panel) for emergency power supply, and unlock the door as the normal operation steps.

When the voltage is lower than 4.8V, the low voltage alarm will be prompted every time you open the lock, please replace the battery in time.

**Note** Do not mix different models, new and old batteries.

### 4.3 Door Lock

#### 1. Outside lock



Up-lifting the handle to lock the door from outside.

#### 2. Inside lock

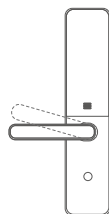

Up-lifting the handle to lock the door from inside.

### 4.4 Trial and error locking

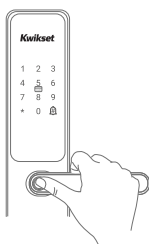

When the number of errors of fingerprints, passwords, and card within 5 minutes is  $\geq 3$  consecutively, there is audible and visual alarm. When the number of errors within 5 minutes is  $\geq 5$  consecutively, the system freezes for 90 seconds, within 90 seconds, any fingerprints, any passwords and any cards can not be identified.

**Note** Each time there is no operation for more than 10 seconds, the system will automatically exit.

## 5. Door opening direction recognition

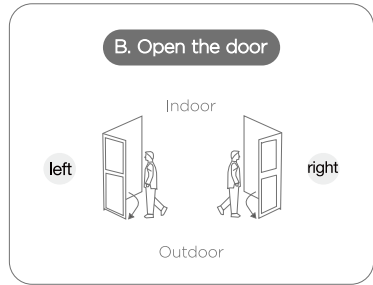
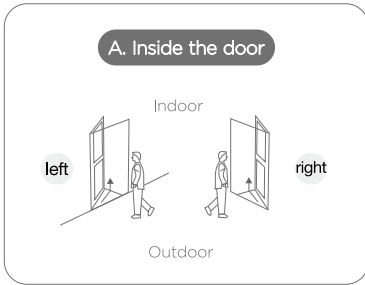

**Note** Before installing the door lock, please confirm the opening direction of the door.

### Reversing latch bolt

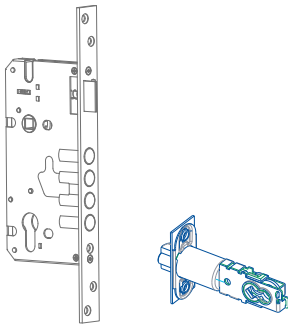

## 6. Scope of application

Scope of application: Residences, Villas, Apartments, Office buildings, etc.

Door thickness: 40mm-100mm. If the door thickness exceeds the specification, you need to inform in advance.

**Note**

Please keep the key safe. It is recommended to put a key in the car or work place in case of emergency.

## 7.Exploded View

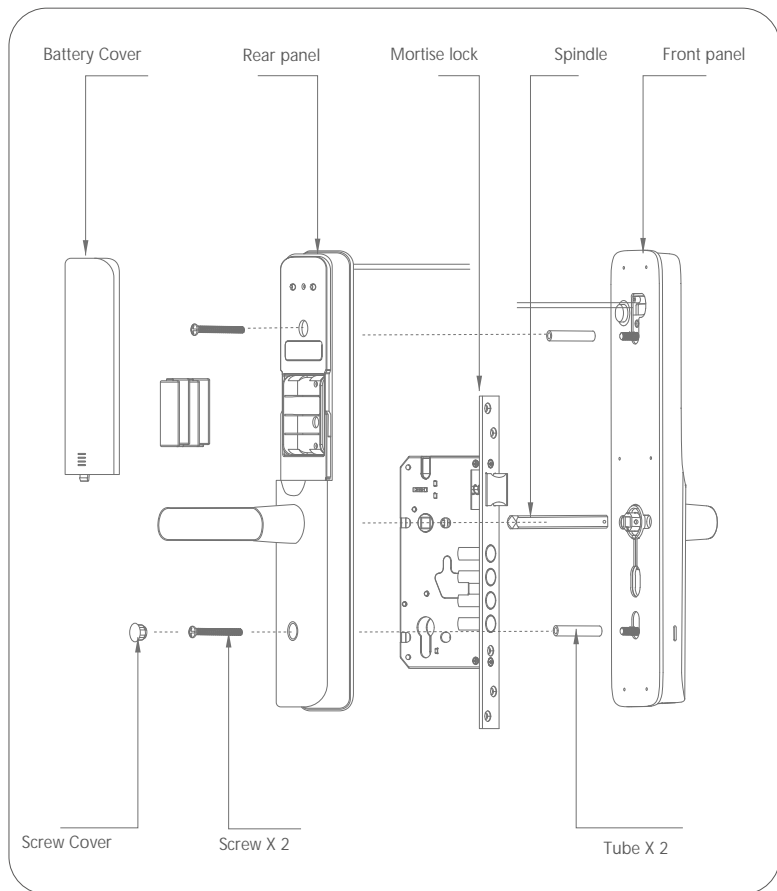

### Parts list

After unpacking, please check the parts according to the list, if you find any omissions, please contact us for it in time

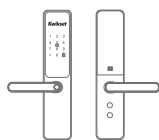

Front & rear panel  
(Included rubber pad)

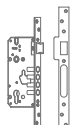

Mortise lock  
& strike plate



Mechanical  
keys X 3



Cards X2



Fitting  
accessories



Template



User manual

## 8. Installation procedure

1) Draw a center line of the opening at 1 meter from the ground inside and outside the door, Drill holes according to the size of the hole drawing.

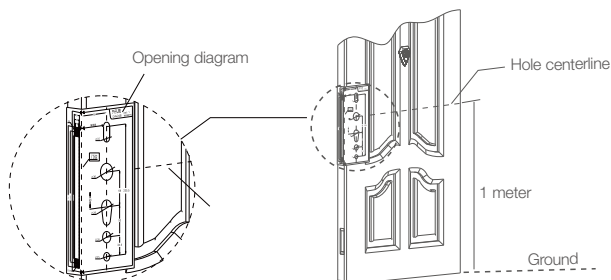

2) Install the mortise lock on the door and fix it with screws.

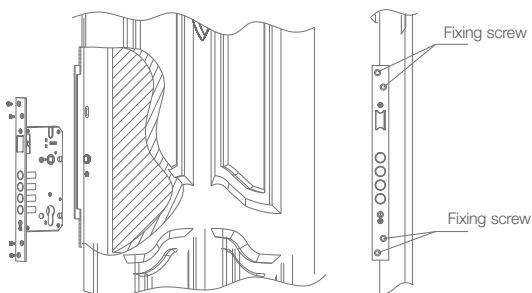

3) Adjust the handle direction according to the door opening direction: If the initial installation direction is inconsistent with the actual one, refer to the back reversing guide of the panel, remove the screw with the allen key, move the handle to the other side, and then reinstall the removed screws. (Details refer picture 1)

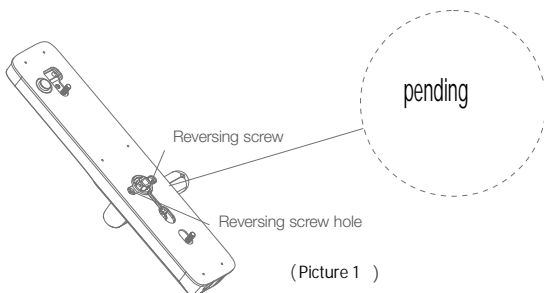

(Picture 1)

## 8. Installation procedure

- 4) First install two connecting wire cylinders on the front panel, then align the convex end of the spindle with the circular hole on the clutch seat and install the upper steel. (Details refer picture 2)

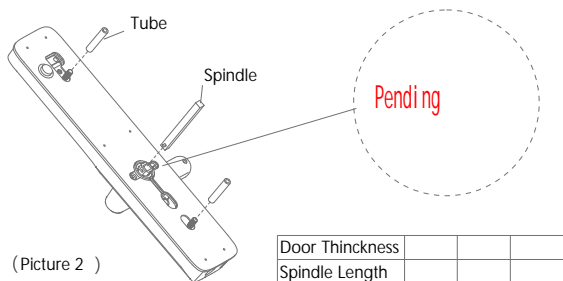

(Picture 2 )

- 5) Pass the connecting wire from the wire hole on the door to the indoor direction, align the square steel with the spindle on the lock body and fasten the front panel to the door. (Details refer picture 3)

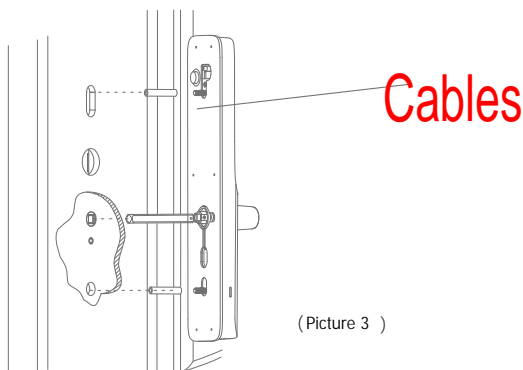

(Picture 3 )

- 6) Insert the front panel cable into the rear panel cable, and fasten the rear panel to the door. (Details refer picture 4)

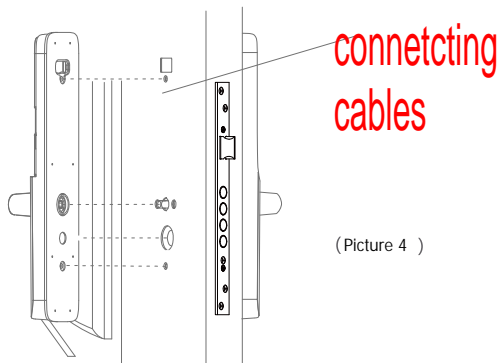

(Picture 4 )

## 8. Installation procedure

---

7) Fix the rear panel with two M5 screws, 1 on the top of the battery box, 1 on the bottom of the rear panel. (Details refer picture 5)

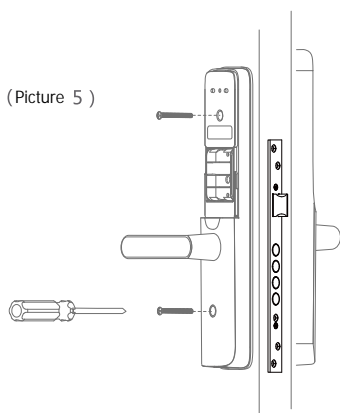

8) Insert 4 AA batteries and cover the bottom with a hole plug 1 screw hole. Close the battery cover and test whether the key, password, fingerprint, and card can open the door normally. (Details refer picture 6)

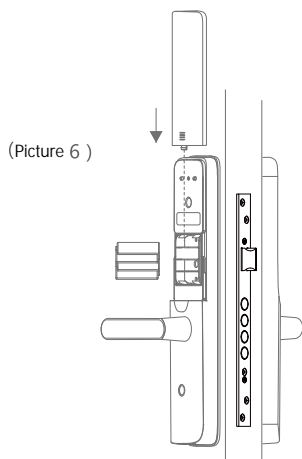

## 9 . Daily maintenance

---

- 1) Don't let the lock surface come into contact with corrosive substances, so as not to damage the protective layer of the lock surface and affect the aesthetics of the lock surface.
- 2) The handle is the key part of the door lock, and its flexibility directly affects the usability of the door lock. Don't hang objects on the handle.
- 3) If the door is deformed, it will cause too much friction when the combination lock tongue enters the door frame and cannot be fully extended. At this time, the position of the door strike plate should be adjusted.
- 4) After the fingerprint collection window is used for a long time, the surface will be stained with dirt or the surface will be wet, please wipe it gently with a dry soft cloth.
- 5) After the low battery alarm, please replace the battery immediately to ensure the normal use of the door lock. When replacing the battery, please pay attention to the positive and negative poles of the battery.
- 6) Please keep the keys properly. It is recommended to keep one key in a safe place outside in case of emergency.
- 7) Don't scratch the fingerprint collection window and touch screen with hard, sharp objects.
- 8) Every time the fingerprint is collected, the fingerprint part of the finger should be pasted flat to the fingerprint identification area.
- 9) If the lock does not turn flexibly or cannot maintain the correct position, Professionals should be asked to add mechanical lubricating oil to the lock body part and the clutch rotating part.
- 10) Always keep the rotating parts of the lock body with lubricant to keep the rotation smooth and prolong the service life.
- 11) It is recommended to check once every six months or a year, and at the same time check whether the tightening screws are loose to ensure the tightening.
- 12) In process of using the lock bladder (Plug), regularly (half a year or a year) or when the key is not smoothly inserted, a little graphite powder or lead powder can be injected into the lock core slot to ensure the smooth insertion and removal of the key. But do not add any other oil to do lubrication, in order to avoid grease sticking to the spring, resulting in the lock core can not rotate and can not be opened.

Certificate of Conformity

Factory date\_\_\_\_\_

Inspector\_\_\_\_\_

The products are inspected and approved to leave the factory.

**\*Please read this manual carefully before using  
the product and keep it properly**

---

Manufacturer:

Address:

Service Hotline:

Website:

Email:

Tel: